

Introduction to Biondi School Adaptive Re-Use Feasibility Study

April 4, 2022

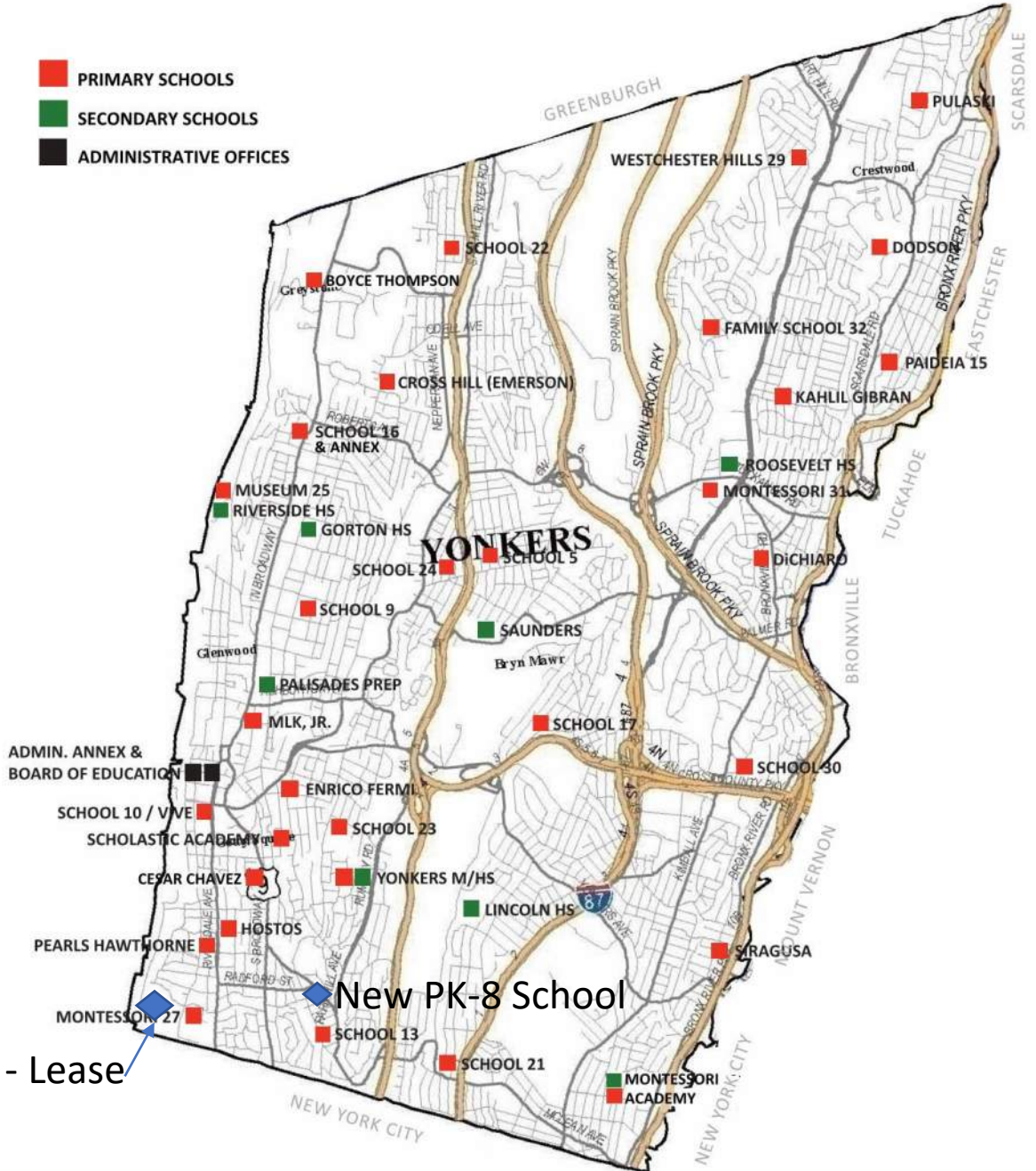

- PRIMARY SCHOOLS
- SECONDARY SCHOOLS
- ADMINISTRATIVE OFFICES

New PK-8 School

Biondi School - Lease

Untitled Map

Write a description for your map.



Google Earth

Image Landsat / Copernicus











0' 8' 16' 32'

SCALE: 1/32"=1'-0"

NORTH

- PROPOSED RECONFIGURED CLASSROOM SPACES
- PROGRAM SPACES
- EXISTING CLASSROOM SPACE
- PROPOSED REMOVED PARTITION

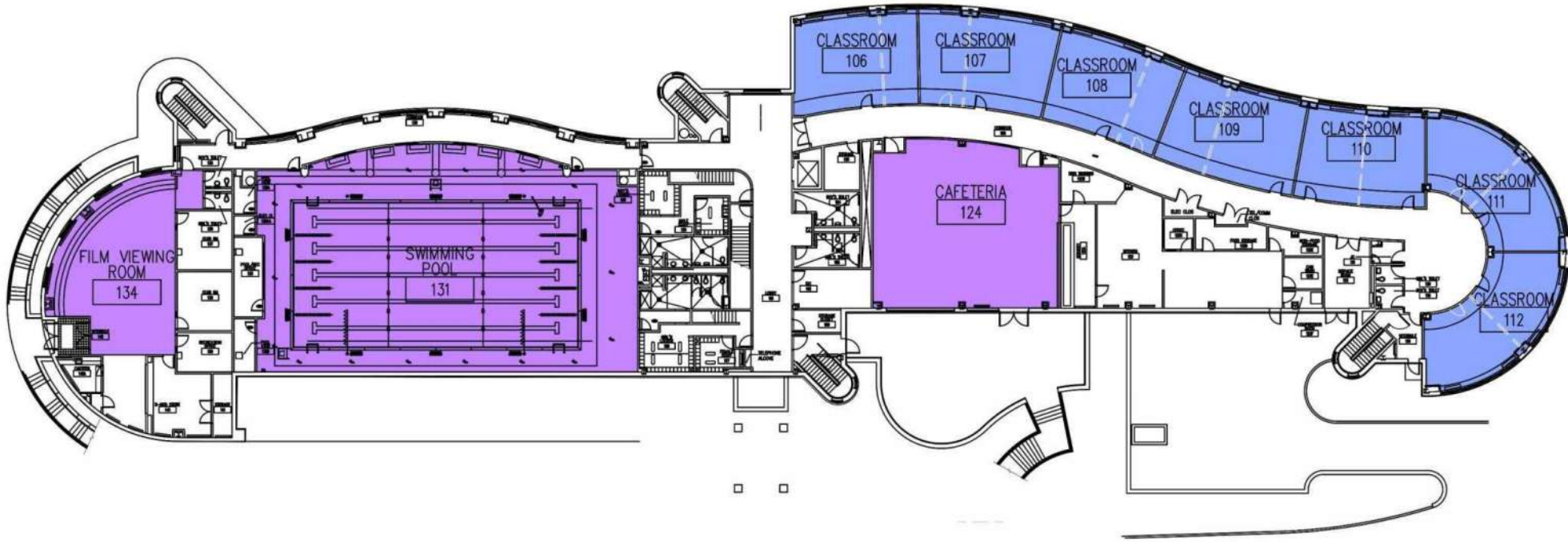

OVERALL FIRST FLOOR LEVEL

0' 8' 16' 32'

SCALE: 1/32"=1'-0"

NORTH

- PROPOSED RECONFIGURED CLASSROOM SPACES
- PROGRAM SPACES
- EXISTING CLASSROOM SPACE
- PROPOSED REMOVED PARTITION

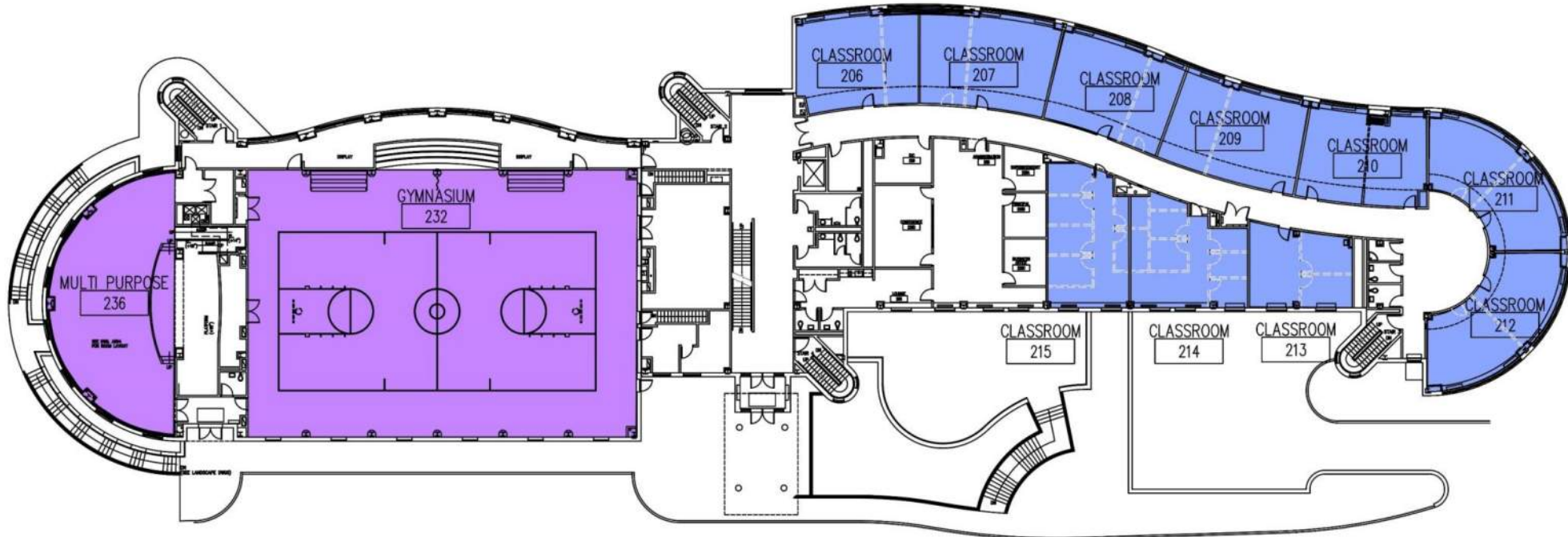

OVERALL SECOND FLOOR LEVEL

0' 8' 16' 32'

SCALE: 1/32"=1'-0"

NORTH

- PROPOSED RECONFIGURED CLASSROOM SPACES
- PROGRAM SPACES
- EXISTING CLASSROOM SPACE
- PROPOSED REMOVED PARTITION

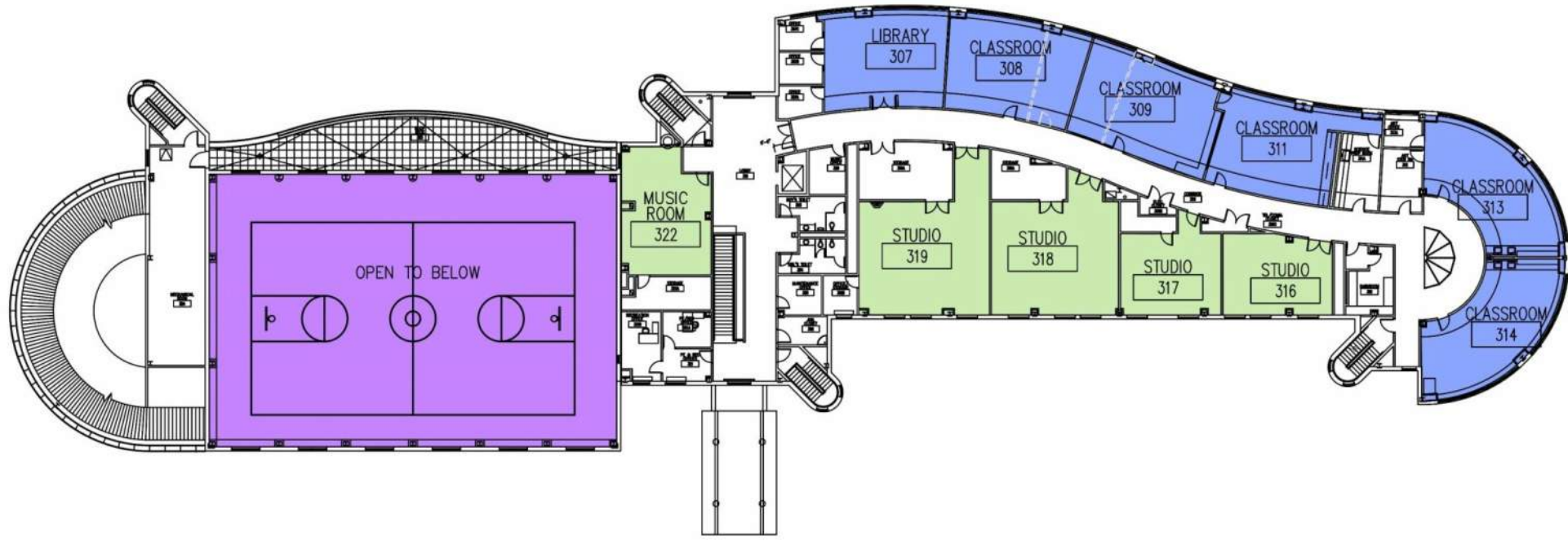

OVERALL UPPER LEVEL

Issues / Next Steps:

- Alignment with YJSCB Plan and YPS Educational Facilities Plan
- SED Preliminary Submission
- Maximum Cost Allowance – Cost of Renovation
- Approval of Lease Payment
- Building Aid Implications
- SEQRA Review
- Building Permit Process
- Site Size Variance